



## Instrument Care

Adjacent strings may break if a missing string is not replaced promptly. Only use the strings suggested by the manufacturer. Improper strings may damage the harp.

Use a dry soft cloth for cleaning. Avoid extreme temperatures. Consider purchasing a soft, padded gig-bag in which to store and transport your harp.

## Accessories

HLLA & HPBY Harps use String Set: RBSHS12F

Books, cases and other harp accessories are available at [www.ensoulmusic.com](http://www.ensoulmusic.com)



**EnSoul**  
MUSIC DESIGNS

[www.ensoulmusic.com](http://www.ensoulmusic.com)

© Copyright 2017, Mid-East Mfg. Inc.  
Mini Harps



## MINI HARPS



– OWNER'S GUIDE –



## Instrument Care

Adjacent strings may break if a missing string is not replaced promptly. Only use the strings suggested by the manufacturer. Improper strings may damage the harp.

Use a dry soft cloth for cleaning. Avoid extreme temperatures. Consider purchasing a soft, padded gig-bag in which to store and transport your harp.

## Accessories

HLLA & HPBY Harps use String Set: RBSHS12F

Books, cases and other harp accessories are available at [www.ensoulmusic.com](http://www.ensoulmusic.com)



**EnSoul**  
MUSIC DESIGNS

[www.ensoulmusic.com](http://www.ensoulmusic.com)

© Copyright 2017, Mid-East Mfg. Inc.  
Mini Harps



## MINI HARPS



– OWNER'S GUIDE –

Roosebeck

# Mini Harps

## Tuning

As you turn the tuning pin, push inward. This will seat the pin securely in the arm of the harp. Only use enough pressure as necessary. New harps require frequent tunings to develop their bright voice. Begin by tuning the 'C' or red strings, then the 'F' or blue strings, finally, the clear strings. Use a piano or an electronic tuner as a reference for tuning; make sure you are in the correct octave.

### NOTES: from Low to High:

**HLLA-K – Lily Harp**, 8 Strings - 15 “ tall  
C5, D5, E5, F5, G5, A5, B5, C6

**HP08 - Parisian Harp**, 8 Strings - 16.5” tall  
F5, G5, A5, B5, C6, D6, E6, F6

**HPBY – Baby Harp™**, 12 Strings – 21 “ tall

### From Low to High:

F4, G4, A4, B4, C5, D5, E5, F5, G5, A5, B5, C6

## Replacing Strings

*Detailed instructions can be found at [www.mid-east.com](http://www.mid-east.com)*

Tie a knot one end of a string. A short piece of string inserted in the knot acts as a brace. Thread the string through the back of the soundboard until the knot is tight against the inside.

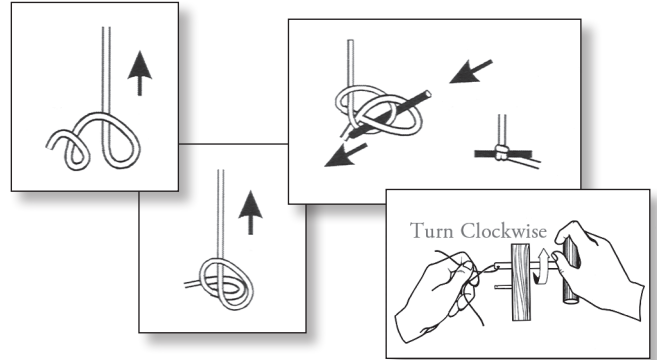

Thread the string through the holes on the Tuning Pin. Pull on the string as you turn the tuning key clockwise, turn until tight. Push the string in the groove of the bridge pin. As you turn, be sure the string is winding, without overlapping. When the proper pitch is reached, trim the end of the string to about half an inch.

Roosebeck

# Mini Harps

## Tuning

As you turn the tuning pin, push inward. This will seat the pin securely in the arm of the harp. Only use enough pressure as necessary. New harps require frequent tunings to develop their bright voice. Begin by tuning the 'C' or red strings, then the 'F' or blue strings, finally, the clear strings. Use a piano or an electronic tuner as a reference for tuning; make sure you are in the correct octave.

### NOTES: from Low to High:

**HLLA-K – Lily Harp**, 8 Strings - 15 “ tall  
C5, D5, E5, F5, G5, A5, B5, C6

**HP08 - Parisian Harp**, 8 Strings - 16.5” tall  
F5, G5, A5, B5, C6, D6, E6, F6

**HPBY – Baby Harp™**, 12 Strings – 21 “ tall

### From Low to High:

F4, G4, A4, B4, C5, D5, E5, F5, G5, A5, B5, C6

## Replacing Strings

*Detailed instructions can be found at [www.mid-east.com](http://www.mid-east.com)*

Tie a knot one end of a string. A short piece of string inserted in the knot acts as a brace. Thread the string through the back of the soundboard until the knot is tight against the inside.

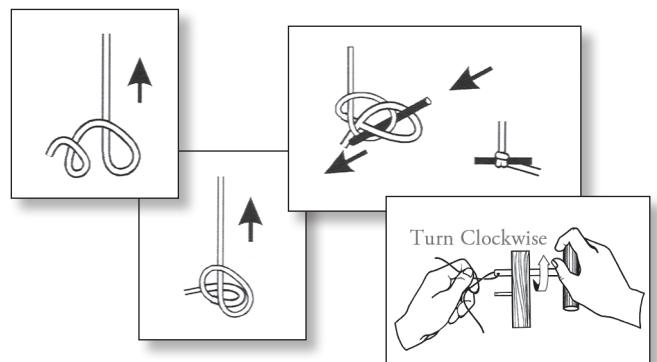

Thread the string through the holes on the Tuning Pin. Pull on the string as you turn the tuning key clockwise, turn until tight. Push the string in the groove of the bridge pin. As you turn, be sure the string is winding, without overlapping. When the proper pitch is reached, trim the end of the string to about half an inch.